

**MBBR 140020 - SPECIFICATIONS:**

**1. DESIGN PARAMETERS:**

- Design Flow Rate: 20,000 GPD - 100,000 GPD

**2. INFLUENT CHARACTERISTICS:**

- TBD

**3. EFFLUENT FINAL QUALITY:**

- TBD

**4. VOLUMES and Areas:**

- TBD from Input and Output Data

**5. MATERIAL OF CONSTRUCTION:**

- TBD from Client's request

**6. SAFETY AND HEALTH:**

- All moving parts to be inaccessible, as required by OSHA

- All electric power elements to be in accordance with OSHA regulations

**7. COATING:**

- TBD from Client's request

**8. WELDING:**

- All welds to conform to AWS applicable specification(s)

**9 BLOWERS**

- Brand: TBD

- Blower Model: TBD

- Power: TBD

- Air flow: TBD

- Noise: TBD

REVISION HISTORY			
REV	DESCRIPTION	DATE	BY/APV
1	---	---	---
2	---	---	---
3	---	---	---
4	---	---	---
5	---	---	---
6	---	---	---
7	---	---	---
8	---	---	---
9	---	---	---
10	---	---	---

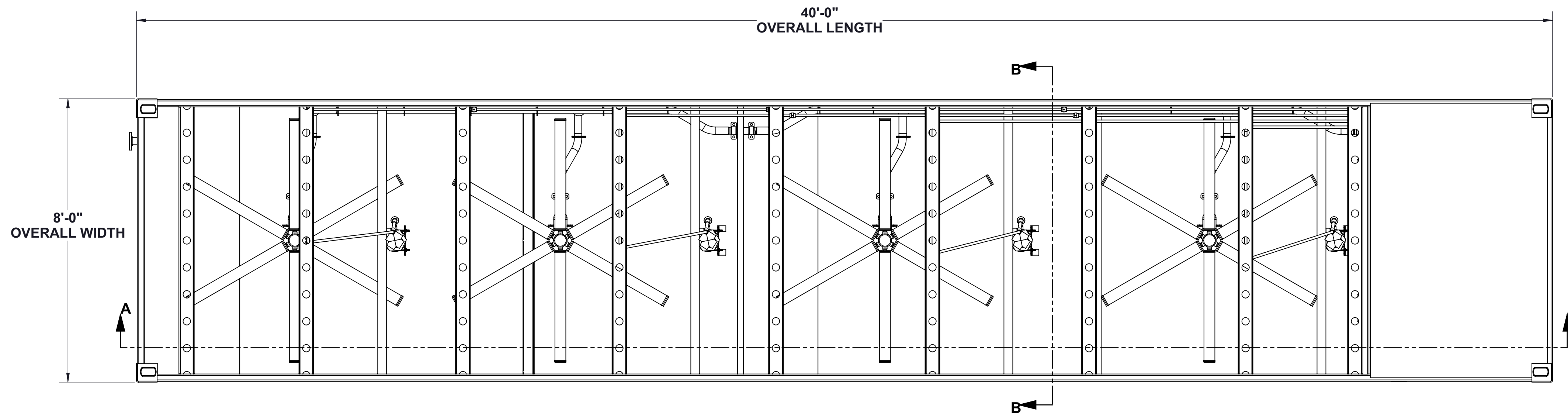

**THIS DRAWING IS FOR SALES ONLY**

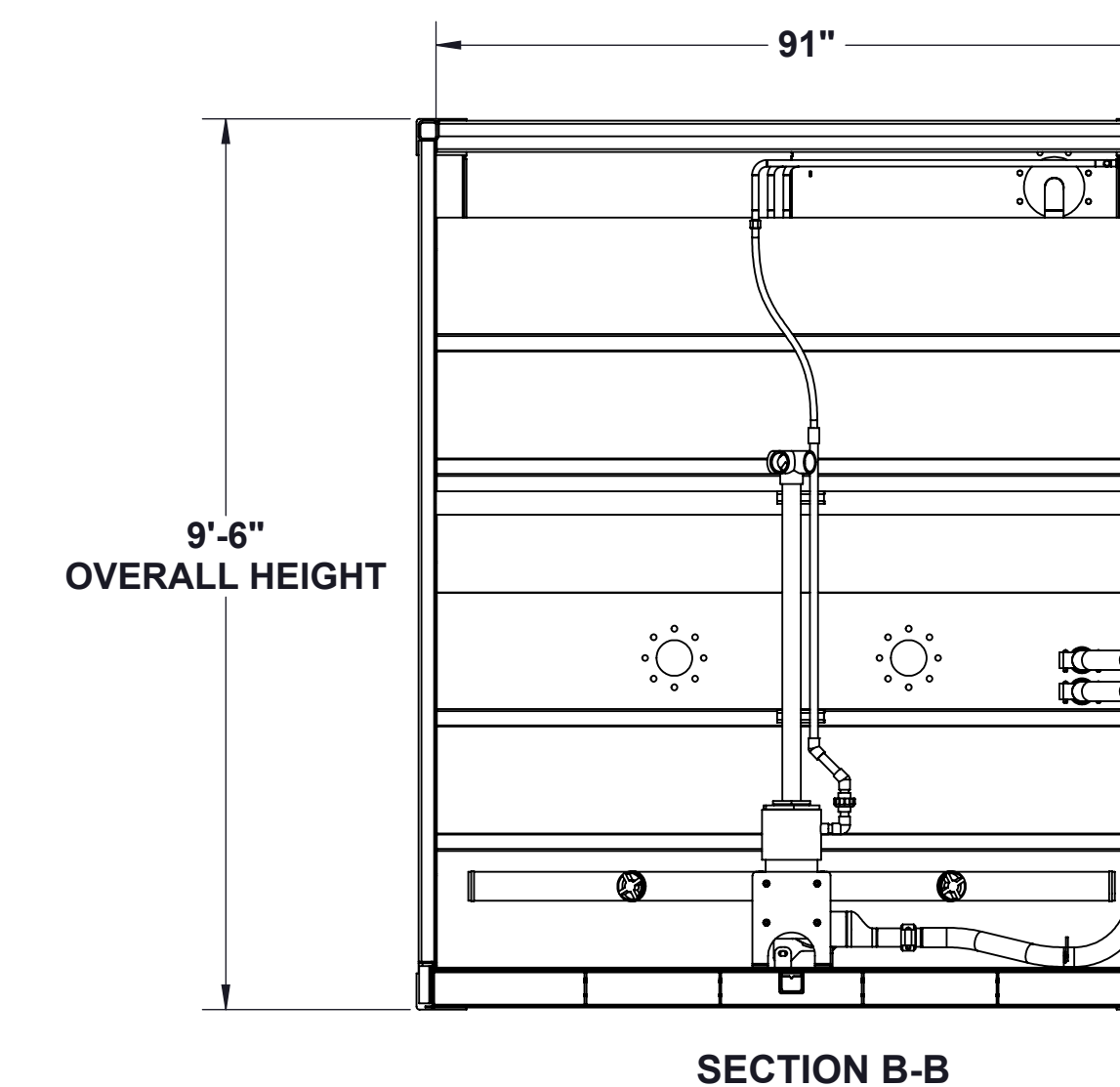
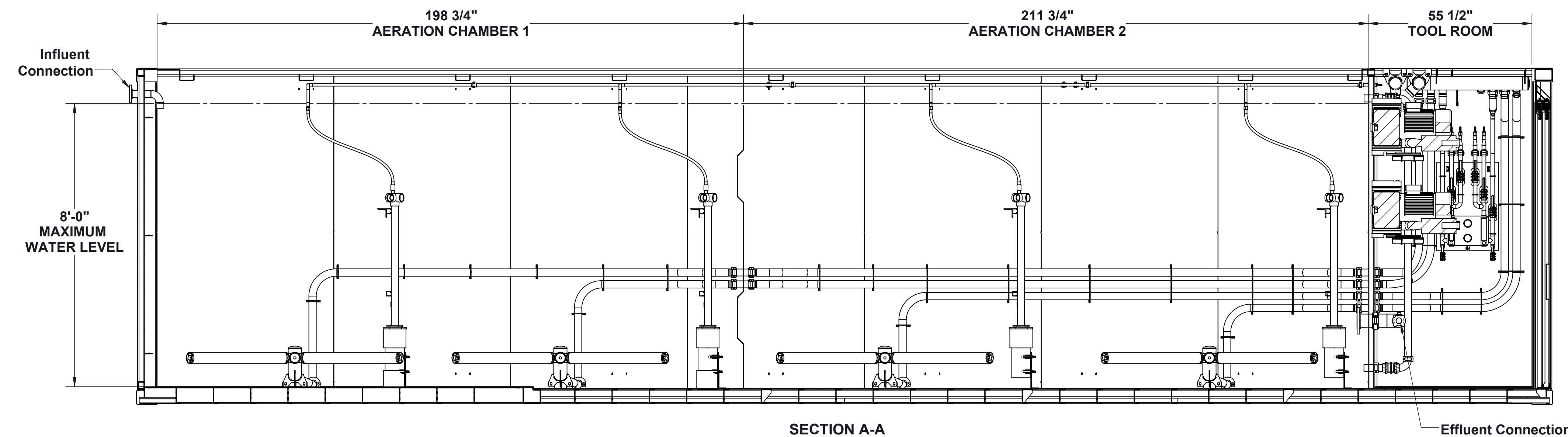

  
**ECOLOGIX**  
 ENVIRONMENTAL SYSTEMS  
 11800 Wills Road Suite 100, Alpharetta, GA 30009  
 Phone: 678-514-2100 Fax: 678-514-2106  
 www.ecologixsystems.com

**Confidential**

This drawing is the exclusive property of Ecologix Environmental Systems, LLC. Its acceptance constitutes an agreement that it shall be treated as strictly confidential. Its use is restricted to those authorized in writing by Ecologix Environmental Systems, LLC and shall be returned upon request. Information contained on or derived from this drawing is not to be communicated, disclosed, used or copied without prior authorization.

	SIGN:	NAME	DATE
DRAWN		NPT	8/8/2016
CHECKED		NPT	8/8/2016
ENG APPR		MDR	8/8/2016
MGR APPR		EG	8/8/2016

UNLESS OTHERWISE SPECIFIED  
 DIMENSIONS ARE IN INCHES  
 ANGLES ±0.5°  
 CUTTING DISTANCE ±1/16"  
 WELDING DISTANCE ±1/8"

**DRAWING TITLE**  
**MBBR 140020**  
 Sales Drawing

SIZE	DRAWING NO.:	REV
D	MBBR 140020	A

FILE NAME: AN00032

MATERIAL:	SCALE:	WEIGHT:	SHEET NO.
	NTS		1 OF 1

LAST UPDATE:

CAD FILE LOCATION: